

# EDITOR BOARD INSTALLATION

---

## UNPACKING AND INSTALLATION

### 1. Accessory Check (FT4490)

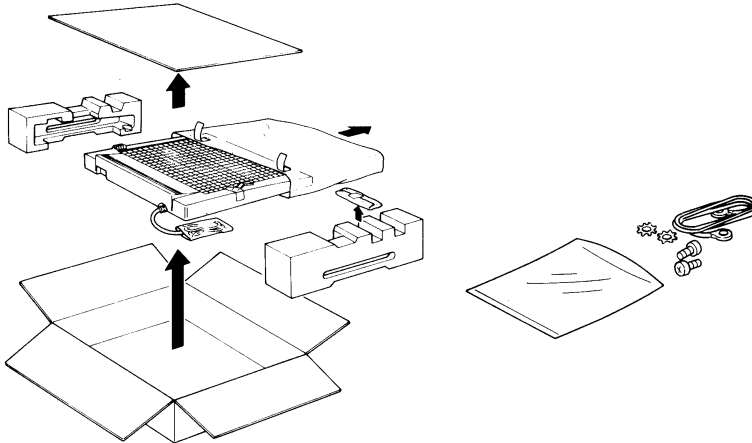

Check the quantity and condition of the accessories in the box according to the following list:

- |  |   |
|--|---|
| 1. Installation Procedure<br>(115V - English only. 220/240V - Five languages)  | 1 |
| 2. New Equipment Condition Report  | 1 |
| 3. NECR Envelope (115V only)   | 1 |
| 4. Operation Instructions<br>(1 15V - English only. 220/240V - Five languages) | 1 |
| 5. stylus  | 1 |
| 6. Cover Plate (FT4480/FT4430 only)  | 1 |
| 7. Ferrite Core (European version only)  | 1 |
| 8. Lock Plate (European version only)  | 1 |
| 9. Clamp   | 2 |
| 10. Multilingual Decal (European Version only only)                            | 1 |
| 11. Pan Head Screw (M4 x 8)  | 1 |
| 12. Ground Screw (European version only)                                       | 2 |
| 13. Toothed Washer (European version only)                                     | 2 |
| 14. Ground Wire (European version only)  | 1 |

# 1. UNPACKING AND INSTALLATION

## - ACCESSORY CHECK (FT4480) -

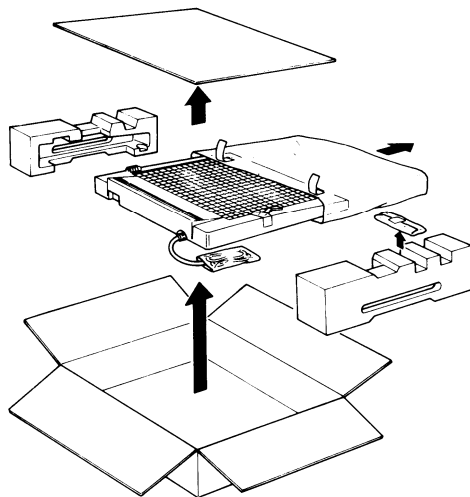

Check the quantity and condition of the accessories in the box according to the following list:

DESCRIPTION	Q'TY
1. Installation Procedure (115V - English only. 220V/240V - five languages)	1
2. New Equipment Condition Report	1
3. NECR Envelope (115V only)	1
4. Stylus Pen	1
5. Cover Plate (FT4480 only)	1
6. Lock Plate (220/240V only)	1
7. Clamp	1
8. Pan Head Screw (M4X8)	1

# EDITOR BOARD INSTALLATION

---

## UNPACKING AND INSTALLATION

### 1. Accessory Check (FT4430)

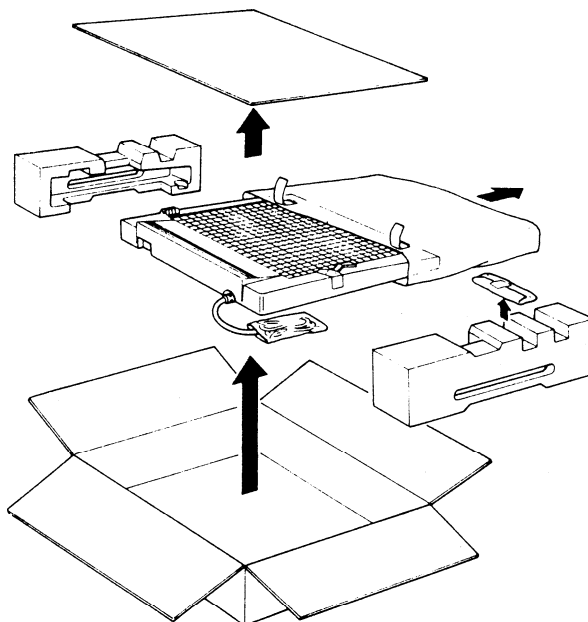

Check the quantity and condition of the accessories in the box according to the following list:

1. Installation Procedure (115V - English only. 220/240V - Five languages)	1
2. New Equipment Condition Report	1
3. NECR Envelope (115V only)	1
4. Operation Instructions (115V - English only. 220/240V - Five languages)	1
5. stylus	1
6. Cover Plate (FT4430 only)	1
7. Ferrite Core (220/240V only)	1
<b>8.</b> Lock Plate (220/240V only)	1
9. Clamp	1
10. Multilingual Decal (220/240V only)	1
11. Pan Head Screw (M4 x <b>8</b> )	1

31 January '89

## 2. Installation Set for RE 11 (FT4490/4480)

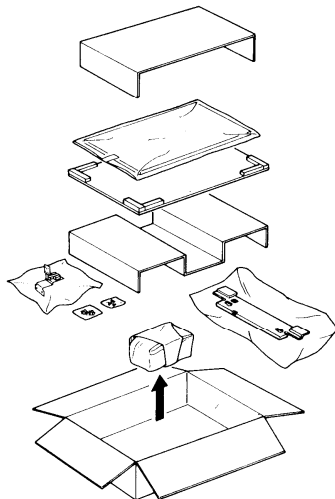

The installation set is required when using the editor as a pressure plate.

Open the box and check the parts according to following list:

- |  |    |
|--|----|
| 1. Pressure Sheet  | 1  |
| 2. Left Hinge  | 1  |
| 3. Right Hinge   | 1  |
| 4. Pan Head Screw (M4 x 12)                                    | 12 |
| 5. Harness Clamp   | 2  |
| 6. Hinge Bracket (FT5560, - 115V only)                         | 1  |
| 7. Mounting Stud (FT5560, - 115V only)                         | 2  |
| 8. Pan Head Screw with Washer (M3 x 6)<br>(FT5560, -115V only) | 2  |

## 2. Installation Set for RE 11 (FT4430)

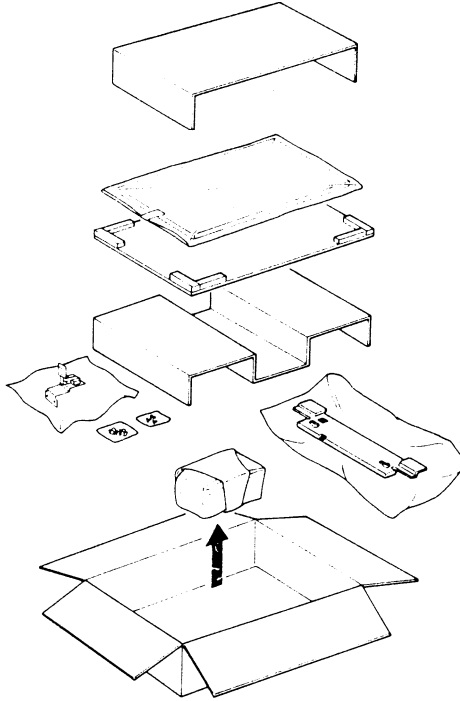

The installation set is required when using the editor as a pressure plate.

Open the box and check the parts according to following list:

1. Pressure Sheet	1
2. Left Hinge	1
3. Right Hinge	1
4. Pan Head <b>Screw (M4 x 12)</b>	<b>12</b>
5. <b>Harness Clamp</b>	<b>2</b>
6 <b>Hinge Bracket (FT5560, - 115V only)</b>	1
7, Mounting Stud (FT5560. - 115V only)	2
8, Pan Head Screw with Washer (M3 x 6) (FT5560, - 115V only)	2

**NOTE:** When installing the editor on this copier, the optional erase lamp (Editing Interface Adapter Type A) is required..

## - INSTALLATION PREPARATION (FT4480) -

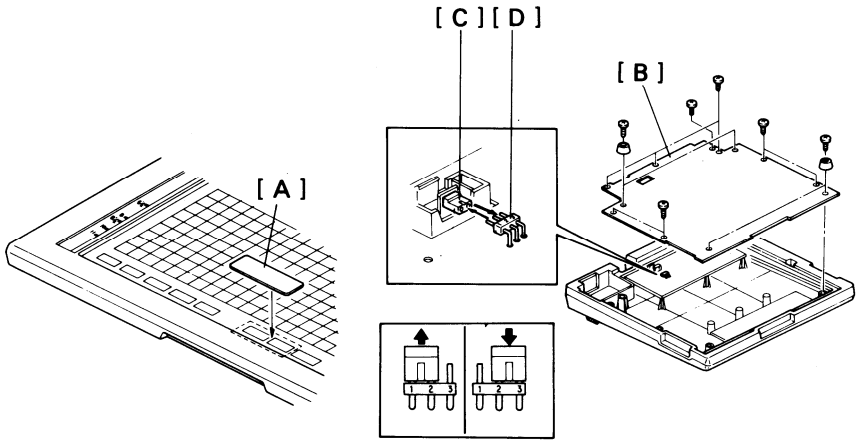

**NOTE:** As this copier does not have either the Save/Shift Image function or the Save/Center Image function, the following procedure prevents the buzzer from sounding if the user mistakenly pushes the Save/Shift Image key or the Save/Center Image key with the stylus pen.

1. Place the cover plate [A] over the Save/Shift Image key and the Save/Center Image key.
2. Remove the bottom plate of the editor [B] (12 screws).
3. Remove the shorting connector [C] from the connector [D] on the PCB.
4. Reinstall the shorting connector, as shown in the figure.
5. Reinstall the bottom plate.

### 3. Installation Procedure (FT4430)

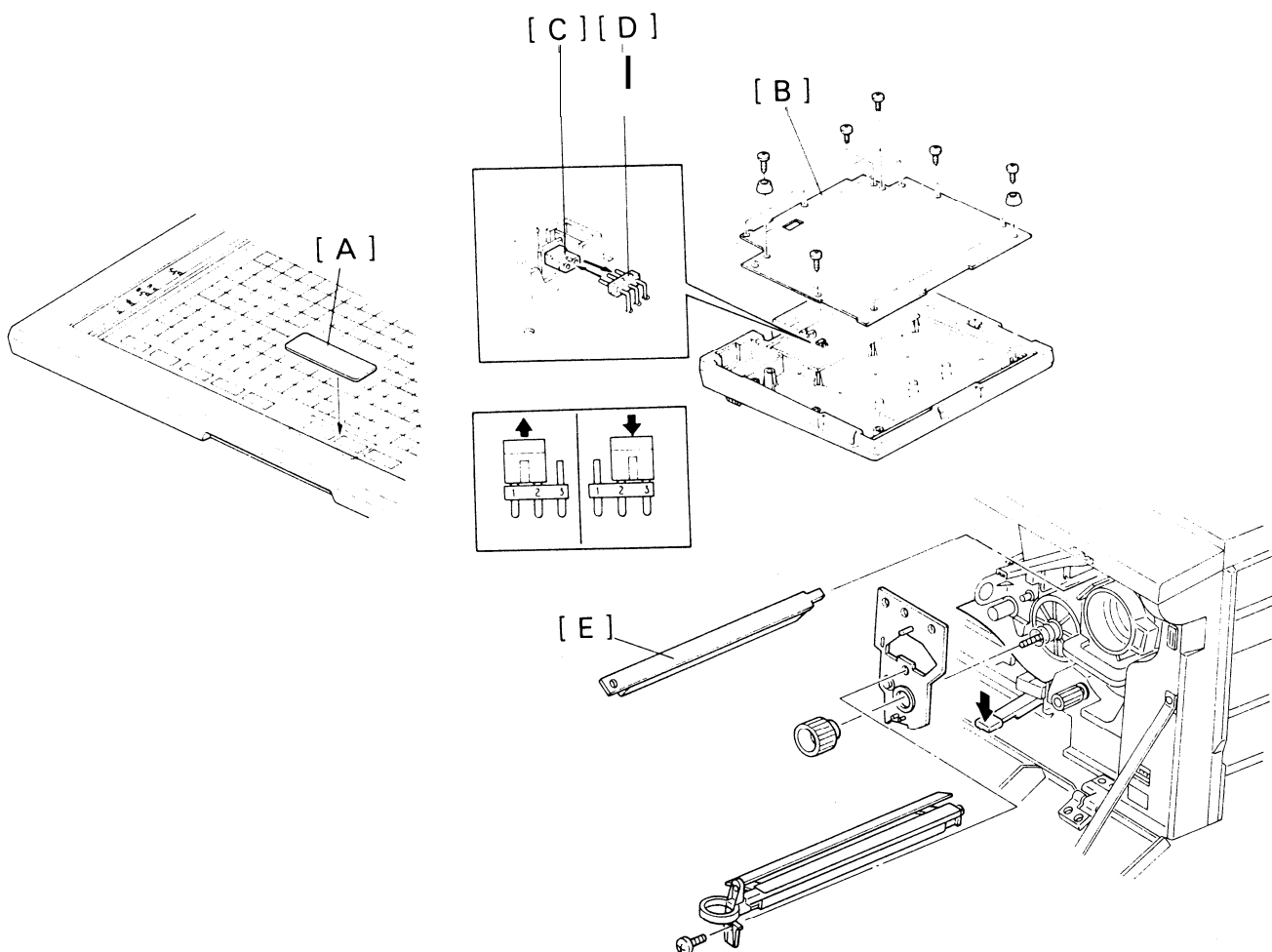

NOTE: - This preparation is only necessary for this **copier**.

- As this copier does not have either the Shift Image-function or the Centering functions, the following procedure prevents the buzzer from sounding if the user mistakenly pushes the Shift Image key or Centering key with the stylus.

1. Place the cover plate [A] over the Shift Image key and the Centering key.
2. Remove the bottom plate [B] of the editor (11 screws).
3. Remove the shorting connector [C] from the connector [D] on the PCB.
4. Reinstall the shorting connector, as shown in the figure.
5. Reinstall the **bottom plate**.
6. **Replace the eraser installed in the machine** with the optional erase lamp [E].
7. Turn on DIP SW 1-8 on the operation panel and change SP Mode No. 45 from "O" to "1".

## 3. Installation Procedure on a Table

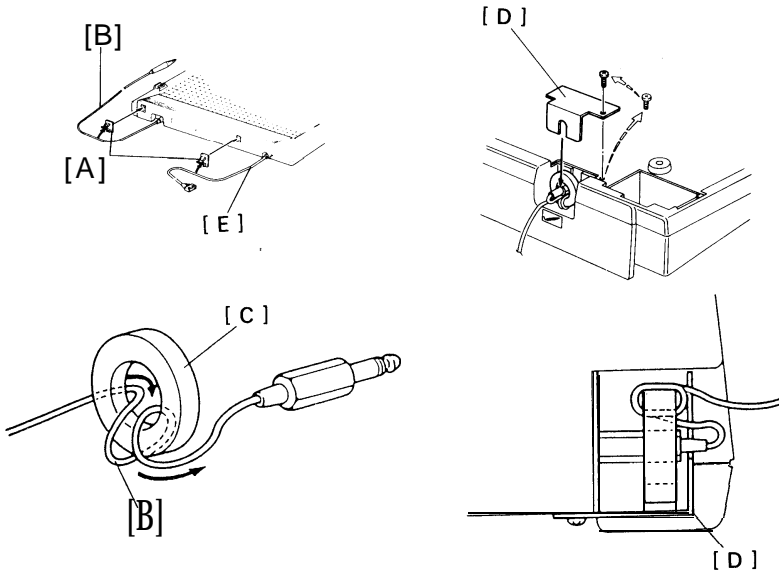

**NOTE:** This procedure is required if the ADF or platen cover is already installed on the machine.

1. Install the clamps [A] on the editor as shown in the figure.
2. Turn the stylus harness [B] twice around the ferrite core [C] as shown in the figure.

**NOTE:** Step 2 is only required in the European machines.

3. Plug the stylus jack into the editor board as shown.
4. Remove the screw securing the bottom plate as shown and secure the lock plate [D] to the bottom plate.

**NOTE:** - Step 4 is only required in the European machines.  
 - Be sure that the lock plate does not damage the stylus harness.

5. Secure the stylus harness and connector harness [E] in the clamps.
6. Place the editor on a table.



31 January '89

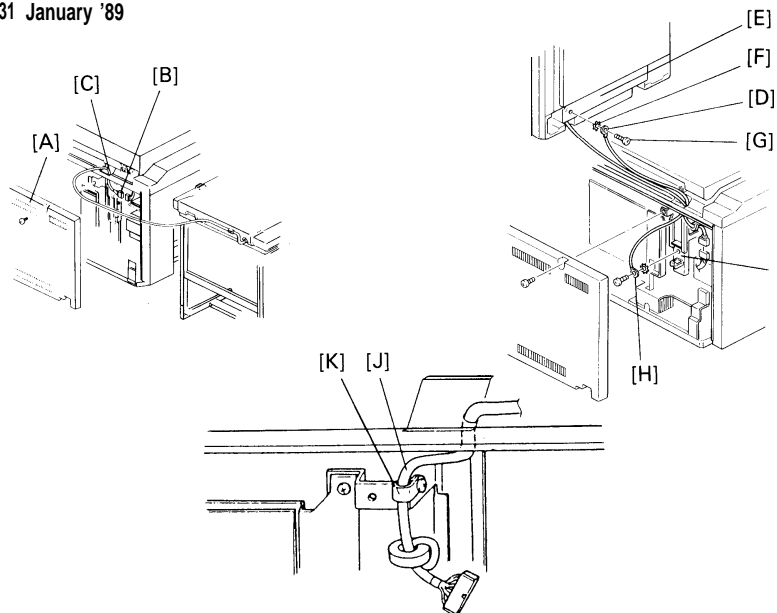

7. Remove the rear cover [A].
8. Connect the editor connector (8 pin) [B] through the docking hole [C] of the DF.

**NOTE:** - If the platen cover is installed on the machine, the connector should be connected through the cutout in the docking hole cap as shown on page 10-7.

- Steps 9, 10, and 11 are only required in the European machines.

9. Secure the ground wire [D] to the bottom plate [E] of the Editor Board (1 toothed washer [F] and 1 ground screw [G]).
10. Pass the ground wire through the docking hole as shown in the figure.
11. Secure the other end of the ground wire [H] to the DF mounting bracket [1] (1 toothed washer and 1 ground screw).
12. Clamp the editor harness [J] and the ground wire to the main board bracket with the nylon wire clamp [K].
13. Reinstall the rear cover.
14. Check the operation of the editor.
15. Fill out the New Equipment Condition Report.

#### 4. Installation Procedure on the Machine

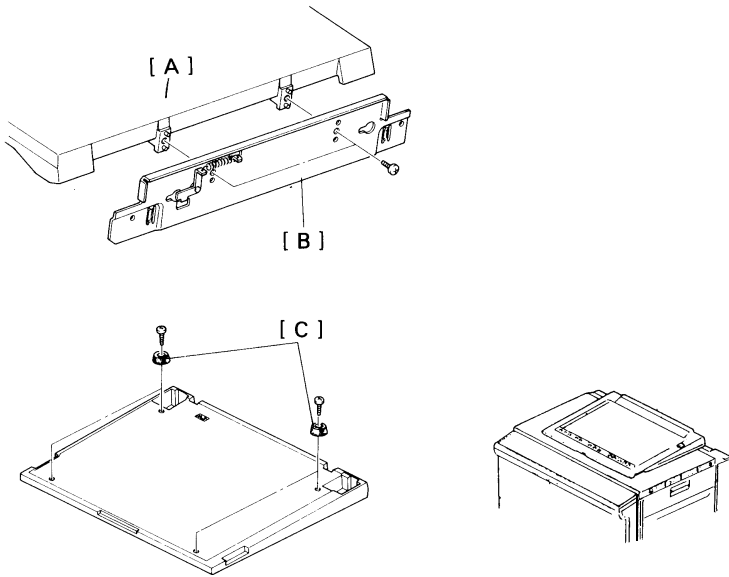

1. Remove the platen cover [A] from the machine.
2. Remove the platen cover hinge bracket [B] from the platen cover.
3. Remove the feet [C] from the editor (4 screws).

31 January '89

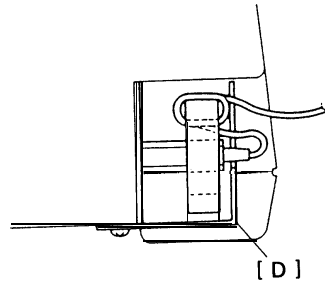
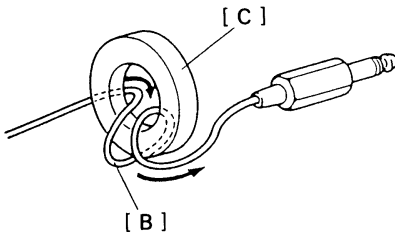
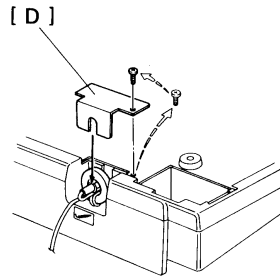
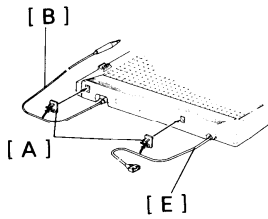

4. Install the clamps [A] on the editor as shown in the figure.
  5. Turn the stylus harness [B] twice around the ferrite core [C].
- NOTE:** Step 5 is only required for European machines.
6. Plug a stylus jack into the editor as shown.
  7. Remove the screw securing the bottom plate and secure the lock plate [D] to it.
- NOTE:** - Step 7 is only required in the European machines.  
- Be sure that the lock plate does not damage the stylus harness.
8. Secure the stylus harness and connector harness [E] in the clamps.

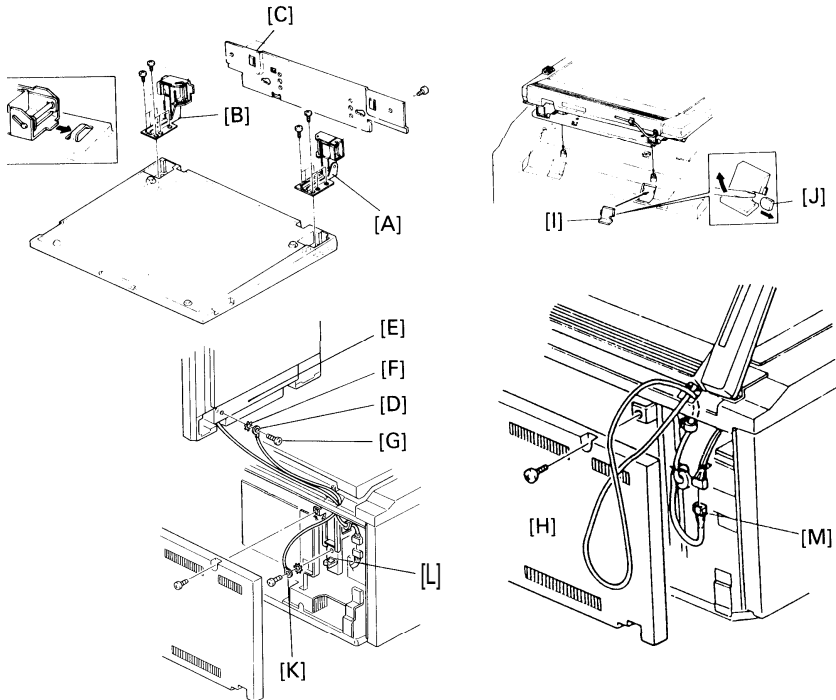

9. Install the left hinge [A] and right hinge [B] on the editor (6 screws each).
10. Install the hinge bracket [C] on the hinges (2 screws).

NOTE: - Use the screws which secure the platen cover to the copier.

- Steps 11, 14, and 15 are only required in the European machines.

11. Secure the ground wire [D] to the bottom plate [E] of the Editor Board (1 toothed washer [F] and 1 ground screw [G]).
12. Remove the rear cover [H] and remove the right docking hole cover [I].
13. Remove the cap [J] from the right docking cover using a small screw driver as shown.
14. Pass the ground wire through the docking hole as shown in the figure.
15. Secure the other end of the ground wire [K] to the DF mounting bracket [L] (1 toothed washer and 1 ground screw).
16. Connect the editor connector (8 pin) [M] through the docking hole and reinstall the docking hole cover on the copier.

31 January '89

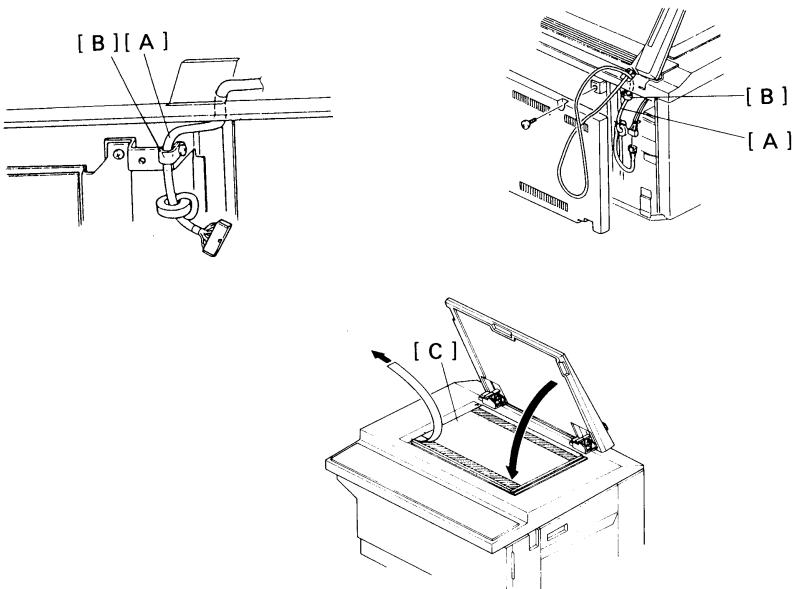

17. Clamp the editor harness [A] to the main board bracket with the nylon wire clamp [B], then reinstall the rear cover.
18. Install the editor on the copier.
19. Put the pressure sheet [C] on the exposure glass so as to align the image area indicators.
20. Remove the seal.
21. Close the editor to complete the installation of the pressure sheet and the editor.
22. Check the operation of the editor.
23. Fill out the New Equipment Condition Report.

# EDITOR BOARD SCHEMATIC

